



Follow these instructions to properly install an N1301 alternator fitted with an N3001 regulator:

1. Remove nut and disc spring washer from shaft, then remove and discard shaft collar.
2. Make sure Woodruff key is securely wedged in shaft slot.
3. Install pulley, disc spring washer, and nut on shaft in that order. See Figure 1. Torque pulley nut to 163 Nm/120 lb. ft.

CAUTION

Do not hammer pulley when installing pulley on shaft. Carefully slip-fit pulley over shaft to prevent shaft from moving out of place.

4. Mount alternator on engine and torque mounting hardware to engine manufacturer's specifications.

CAUTION

Failure to tighten slip bushing in rear mounting foot against mounting bracket can result in broken mounting feet or broken bracket.

5. Install belt on pulley and tension belt to engine manufacturer's recommendation (typically 80-120 lbs).

CAUTION

All cables must be supported within 300 mm (12 in.) to prevent twisting, loosening, and damage to terminals.

6. Connect vehicle harness to alternator output receptacle as shown in Figure 2.
7. Connect vehicle B- cable to alternator B- terminal. See Figure 2. Install cable hardware in stacking order shown in Figure 3. Torque B- terminal bolts to 14 Nm/10 lb. ft.
8. Install N3001 regulator according to instructions on page 2.

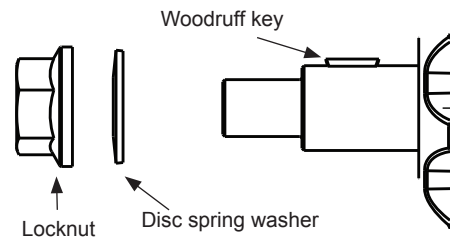

Figure 1: Pulley Installation

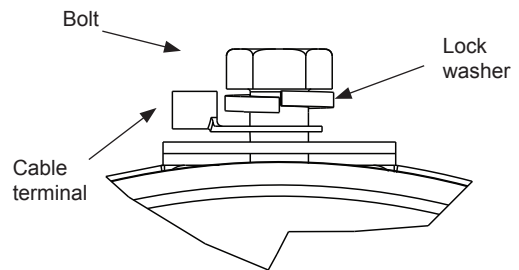

Figure 3: B-Terminal Hardware Stacking Order

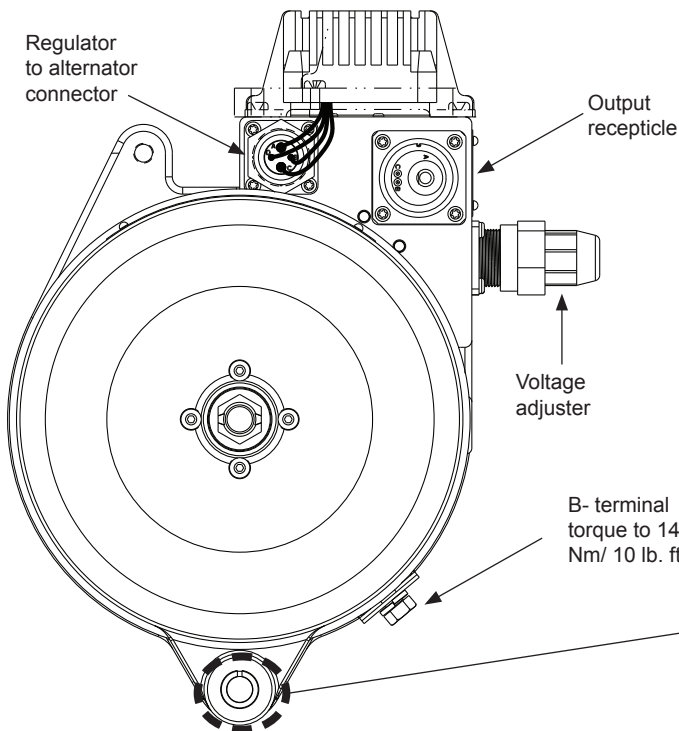
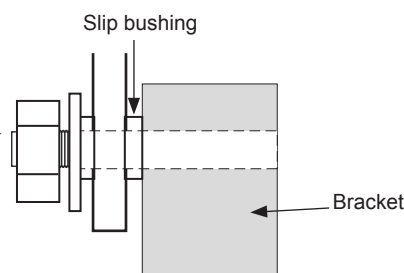

Figure 2: N1301 Alternator Installation



N3001 Regulator Installation

1. Align regulator tabs with screw holes on alternator shell and secure with mounting screws. Torque screws to 3.4 Nm/30 lb. in. See Figure 4.
2. Connect regulator to alternator harness to receptacle on alternator.

CAUTION

All cables must be supported within 300 mm (12 in.) to prevent twisting, loosening, and damage to terminals.

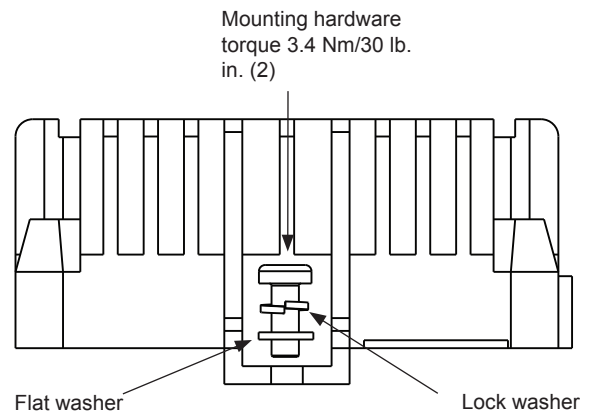

Figure 4: Mounting N3001 Regulator

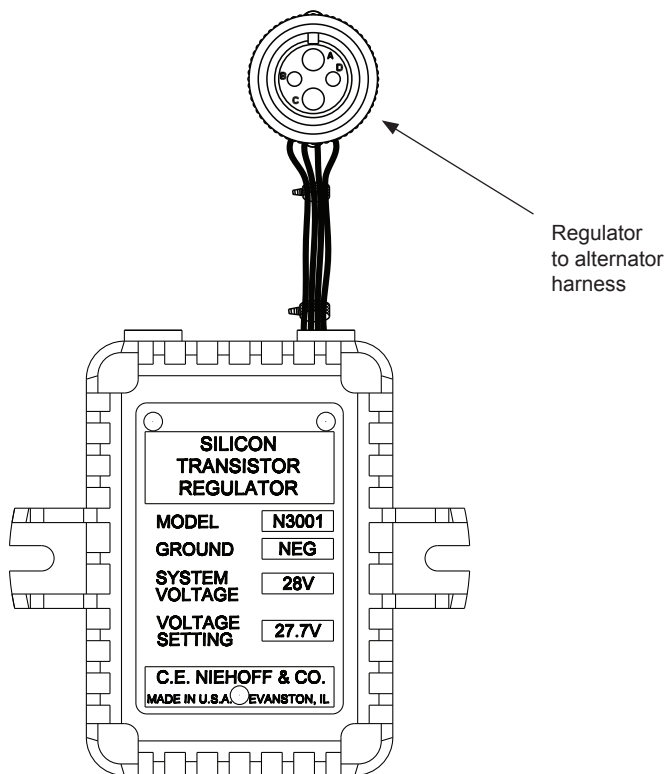

Figure 5: N3001 Regulator

If you have questions about your alternator or these instructions, or if you need to locate a Factory Authorized Service Dealer, please contact us at:
C. E. Niehoff & Co. • 2021 Lee Street • Evanston, IL 60202 USA
TEL: 800.643.4633 USA and Canada • TEL: 847.866.6030 outside USA and Canada • FAX: 847.492.1242
E-mail us at service@CENiehoff.com